

# Grand Valley State University

## Haas Performing Arts Center Garden

10610 South Campus Drive  
Allendale, MI 49401

Issued For Construction January 30, 2023  
Project Number 221246



Engineers | Architects | Scientists | Constructors

fishbeck.com  
800.456.3824

1515 Arboretum Drive  
Grand Rapids, Michigan

LOCATION MAP

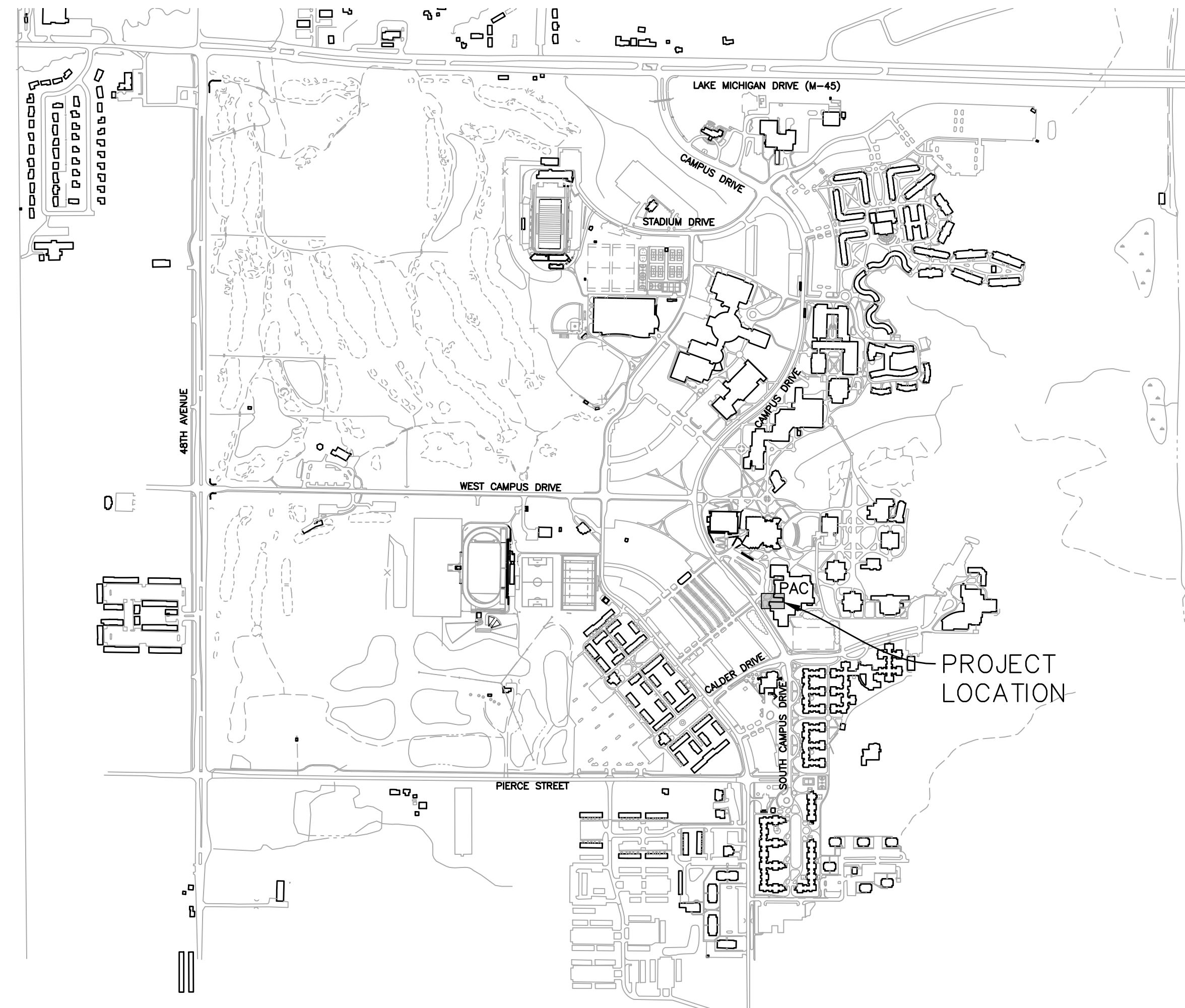

**CIVIL**

- G101 COVER
- C101 EXISTING CONDITIONS, DEMOLITION & SESC PLANS
- C201 SITE LAYOUT & GRADING PLAN

**LANDSCAPE**

- L101 LANDSCAPE PLAN & DETAILS

PLOT INFO: Z:\2022\221246\CADD\DWG\101221246.DWG LAYOUT: G101 DATE: 2/9/2023 TIME: 2:30:27 PM USER: MVYSOKY



**Grand Valley State University**  
10610 South Campus Drive, Allendale, MI 49401  
Haas Performing Arts Center Garden

REVISIONS

01/30/2023 FOR CONSTRUCTION

Drawn By ADO  
Designer MAV  
Reviewer  
Manager MV

Hard copy is intended to be 24"x36" when plotted. Scale(s) indicated and graphic quality may not be accurate for any other size.

PROJECT NO.  
221246

SHEET NO.

**G101**



*Mark Vysoky*

© Copyright 2022  
All Rights Reserved

**SESC NOTES**

1. THE CONTRACTOR SHALL PROVIDE FOR PROPER SOIL EROSION AND SEDIMENTATION CONTROL INCLUDING ALL LABOR, MATERIAL AND EQUIPMENT REQUIRED FOR FURNISHING, INSTALLING, MAINTAINING, AND REMOVING EROSION CONTROL DEVICES AS DETAILED ON THIS SHEET OR AS DETERMINED BY THE ENGINEER. ADDITIONALLY, THE CONTRACTOR IS RESPONSIBLE FOR OBTAINING LUDD SESC PERMIT, APPLICATION, INSPECTION, ALL ASSOCIATED FEES, NECESSARY INSURANCE AND BONDING AS REQUIRED.
2. COMPLY WITH ALL TERMS OF THE SOIL EROSION CONTROL PERMIT AND SPECIFICATIONS.
3. PROVIDE SOIL EROSION AND SEDIMENTATION CONTROL MEASURES PRIOR TO STARTING DEMOLITION, EARTHWORK AND EXCAVATION. MEASURES INDICATED ON THESE DRAWINGS ARE MINIMUM REQUIREMENTS. SUPPLEMENT THESE REQUIREMENTS AS REQUIRED BY CONSTRUCTION PHASING AND SITE CONDITIONS TO COMPLY WITH PERMIT.
4. PROVIDE AND MAINTAIN SILT FENCE IN ACCORDANCE WITH THE MANUFACTURER'S RECOMMENDATIONS. MAINTENANCE INCLUDES THE REMOVAL OF BUILT-UP SEDIMENT WHEN THE SEDIMENT ACCUMULATES TO 1/3 OF THE HEIGHT OF THE SILT FENCE. REMOVE, REPLACE, RETRENCH, OR RE-BACKFILL THE SILT FENCE IF IT FAILS. REINSTALL FENCE DAMAGED BY CONSTRUCTION.
5. PER UNIVERSITY STANDARDS, CONTRACTOR MUST INSPECT SOIL EROSION CONTROL MEASURES WEEKLY AND WITHIN 24 HOURS OF EVERY RAIN EVENT. ANY SEDIMENTATION, REPORT & RECORD ALL INSPECTIONS. DEFECTS OR FAILURES MUST BE CORRECTED IMMEDIATELY.
6. SOIL EROSION CONTROL MEASURES AT TOPSOIL STOCK PILE AND EXCAVATED SPOIL LOCATIONS ARE TO BE INSTALLED AND MAINTAINED BY CONTRACTOR. MEASURES WILL INCLUDE SILT FENCING AROUND SOIL PILES, TEMPORARY SEEDING, MULCHING, AND INLET PROTECTION AS NEEDED.
7. CONTRACTOR TO USE APPROPRIATE MEASURES DURING CONSTRUCTION TO CONTROL AIRBORNE SEDIMENTATION, INCLUDING WATERING EXPOSED CLAY SOIL, PLACING WIND FENCING AROUND EXPOSED SOIL SURFACES AND PLANTING TEMPORARY VEGETATION.
8. PROMPTLY REMOVE ALL MUD, DIRT, AND DEBRIS TRACKED ONTO EXISTING ROADS AND SIDEWALKS FROM THE SITE ON A DAILY BASIS.
9. SITE SOILS: URBAN FILL (I.E. MEDIUM DENSE POORLY GRADED SAND, CLAYEY SAND, OR VERY STIFF LEAN CLAY WITH SAND)
10. LIMITS OF DISTURBANCE 2,820 SF.

**DEMOLITION NOTES**

1. FIELD VERIFY THE EXTENT OF REMOVALS AND DEMOLITION
2. PRIOR TO CONSTRUCTION, NOTIFY ENGINEER OF ANY DEVIATIONS FROM INFORMATION SHOWN.
3. PRIOR TO CONSTRUCTION ALL FENCING, BARRICADES, ENCLOSURES, ETC., MUST BE INSTALLED AND APPROVED BY OWNER OR CONSTRUCTION MANAGER.
4. DISPOSE OF DEMOLITION AND EXCAVATION MATERIALS IN ACCORDANCE WITH CONTRACT DOCUMENTS.
5. SOIL EROSION AND SEDIMENTATION CONTROL MEASURES MUST BE IN PLACE PRIOR TO STARTING REMOVALS AND DEMOLITION.
6. UNLESS SPECIFICALLY NOTED FOR REMOVAL ON THE PLANS, PROTECT ALL SIDEWALKS, DRIVES, CULVERTS, DRAINAGE STRUCTURES, AND ABOVE AS WELL AS BELOW GRADE UTILITIES. REMOVE AND REPLACE ALL SUCH ITEMS DAMAGED OR DESTROYED DURING CONSTRUCTION WITH NEW AT NO ADDITIONAL COST TO THE OWNER.
7. PROTECT EXISTING TREES TO REMAIN WITH TEMPORARY FENCING AT THE DRIP LINE. NO GROUND DISTURBANCE OR STORAGE OF MATERIAL/EQUIPMENT SHALL OCCUR WITHIN THE DRIP LINE LIMITS.
8. COORDINATE REMOVAL OR REPLACEMENT OF ELECTRICAL, TELEPHONE, CABLE TV, WATER, FIBER OPTIC CABLE AND/OR GAS LINES WITH THE AFFECTED UTILITY COMPANY. PROVIDE ADEQUATE TIME SHALL BE PROVIDED FOR RELOCATION AND CLOSE COORDINATION WITH THE UTILITY COMPANY AS NECESSARY TO PROVIDE A SMOOTH TRANSITION IN UTILITY SERVICE. PAY CLOSE ATTENTION TO EXISTING UTILITIES WITHIN THE CONSTRUCTION LIMITS. GIVE NOTICE TO ALL UTILITY COMPANIES REGARDING DESTRUCTION AND REMOVAL OF ALL SERVICE LINES AND CAP ALL LINES BEFORE PROCEEDING WITH THE WORK.
9. PERFORM CLEARING, GRUBBING, TREE AND STUMP REMOVAL, TOPSOIL REMOVAL AND STOCKPILING IN ACCORDANCE WITH THE CONTRACT DOCUMENTS.
10. BEFORE REMOVING OR ABANDONING ANY UTILITY PIPES, VERIFY NEW UTILITY PIPE HAS BEEN INSTALLED, TESTED AND IS OPERATIONAL.
11. THE LOCATIONS OF ALL EXISTING UTILITIES SHOWN ON THIS DRAWING HAVE BEEN DETERMINED FROM THE BEST INFORMATION AVAILABLE AND ARE GIVEN FOR THE CONVENIENCE OF THE CONTRACTOR. VERIFY CRITICAL INVERT INFORMATION PRIOR TO BEGINNING CONSTRUCTION.
12. SAWCUT AND REPLACE DAMAGE CAUSED TO SURROUNDING AREA PAVEMENT OUTSIDE THE CONSTRUCTION LIMITS AT NO ADDITIONAL COST TO THE OWNER.
13. COORDINATE SEQUENCING AND PHASING OF DEMOLITION WITH CONSTRUCTION MANAGER.
14. SEE OTHER DRAWINGS FOR ADDITIONAL SITE DEMOLITION WORK.
15. SAWCUT CURB AND GUTTER AND SIDEWALKS TO NEAREST JOINT.
16. SALVAGE EXISTING TOPSOIL FOR REUSE ON SITE.

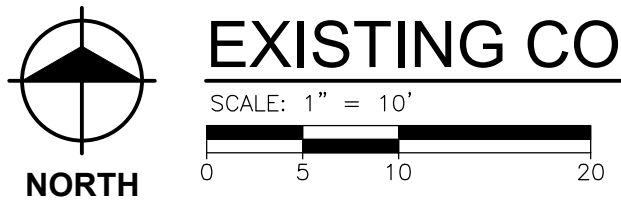
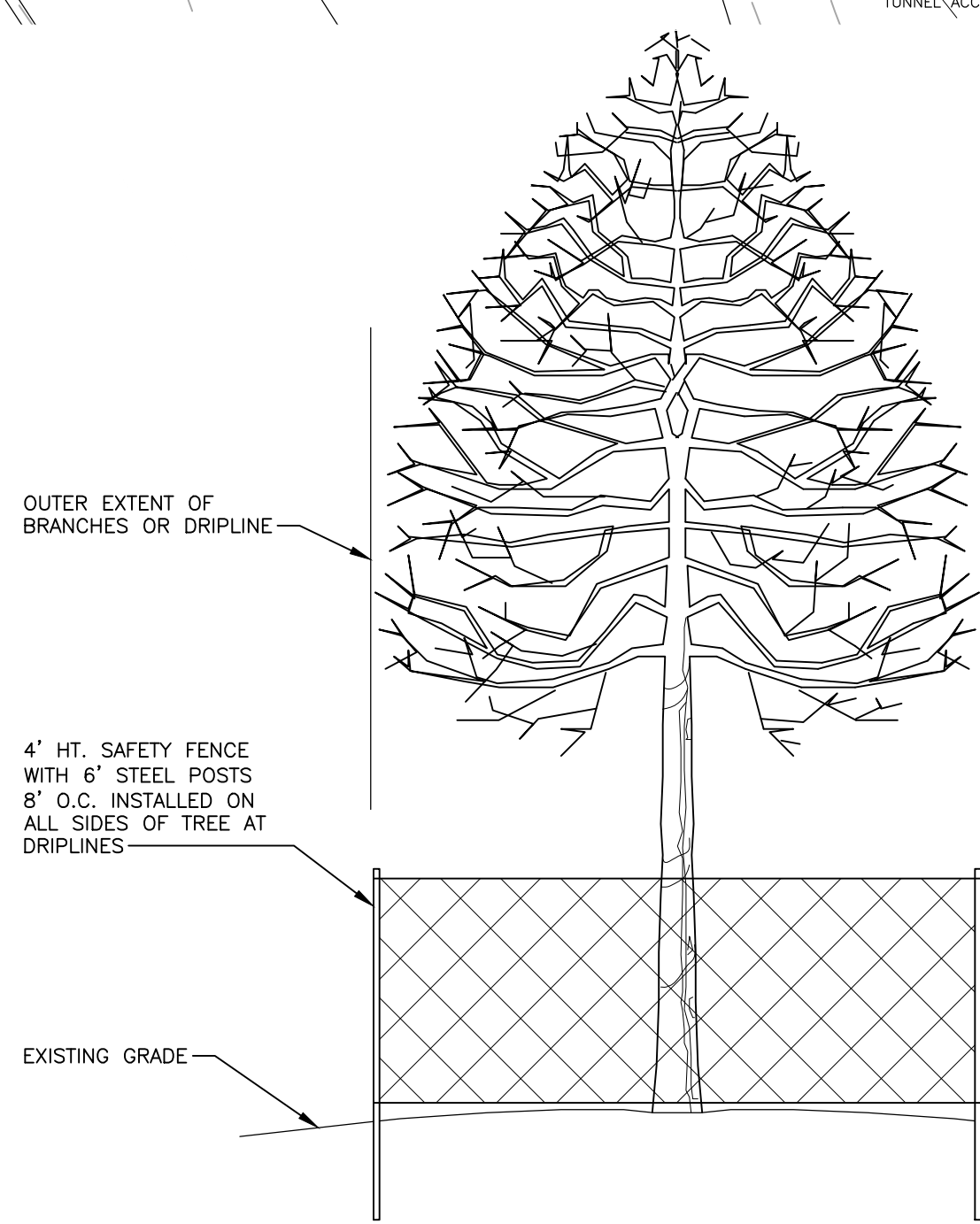
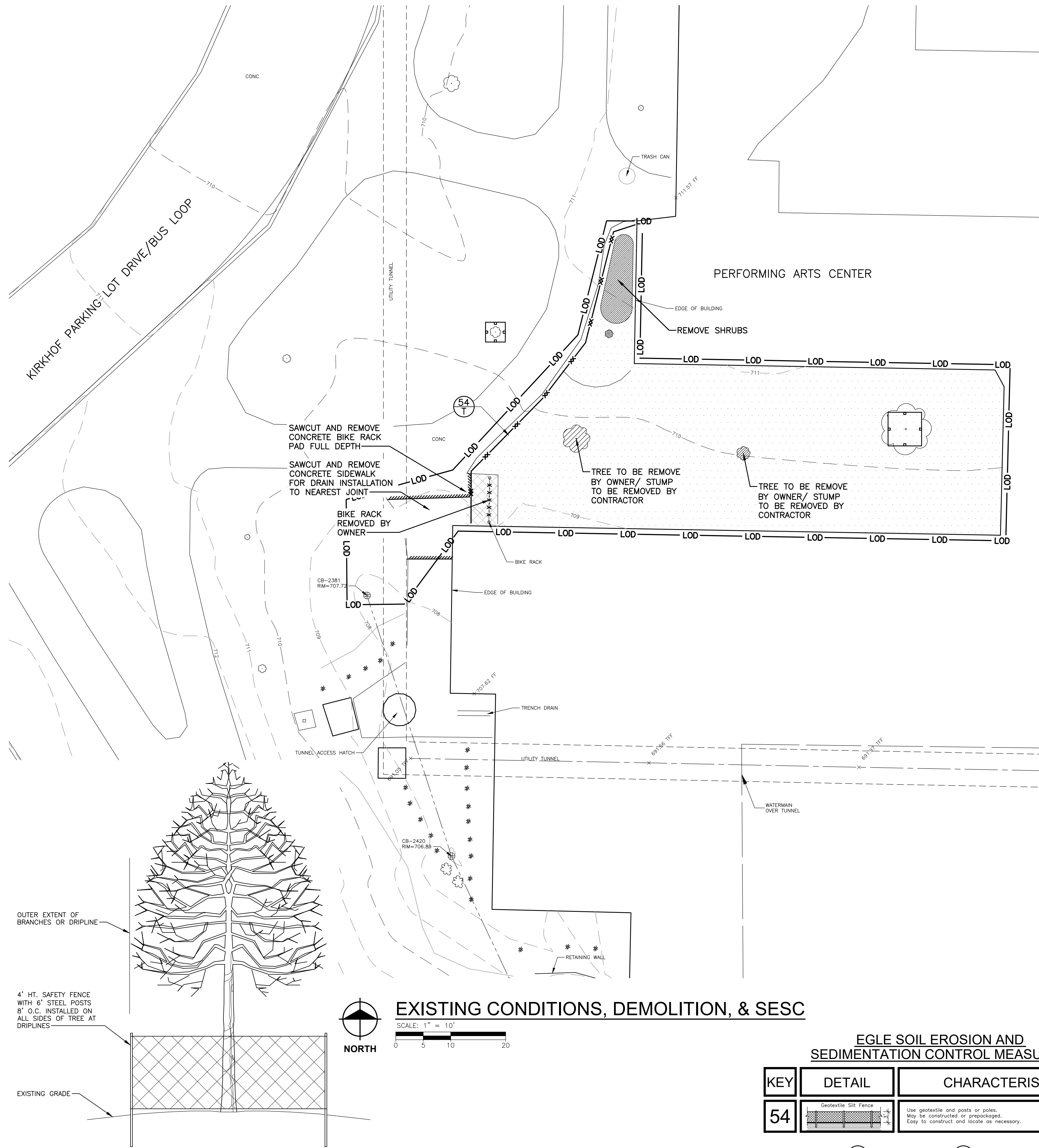

**EXISTING CONDITIONS, DEMOLITION, & SESC**

**EGLE SOIL EROSION AND SEDIMENTATION CONTROL MEASURES**

KEY	DETAIL	CHARACTERISTICS
54		Use geotextile and posts or poles. May be constructed or prepackaged. Easy to construct and locate as necessary.

- XX TEMPORARY MEASURE
- YY PERMANENT MEASURE

**MICHIGAN 811**  
 3 full working days before you dig:  
 1-800-482-7171  
 on the web at: www.missdig.org

**BENCHMARKS**

- BENCH MARK A ELEVATION: 707.86  
 CHISELED X ON NORTH BOLT OF BIG LIGHTPOLE BASE, SOUTH OF ZUMBERGE POND, BETWEEN KIRKHOFF PERFORMING ARTS CENTER AND ZUMBERGE
- BENCH MARK B ELEVATION: 711.60  
 CHISELED X ON TOP OF SSE BOLT ON LIGHT POLE BASE, WESTERLY SIDE OF SOUTH CAMPUS DRIVE, NORTH OF CALDER

**SYMBOL LEGEND**

- BENCH MARK
- SHRUBS
- CONIFEROUS TREE
- DECIDUOUS TREE
- CONTOUR MAJOR
- CONTOUR MINOR
- LIGHT
- UTILITY POLE
- SIGN
- FENCE LINE
- GRAVEL SURFACE
- PAVED SURFACE
- EXISTING CURB & GUTTER
- 12" STM. STORM SEWER & MANHOLE
- CATCH BASIN CURB AND LAWN TYPE
- VALVE
- HYDRANT
- 6" WTR. WATER MAIN
- PLUG
- ELEC. UNDERGROUND ELECTRIC
- LOD LIMIT OF DISTURBANCE
- SAWCUT
- OBJECT REMOVAL
- REMOVE TURFGRASS, MULCH, AND LANDSCAPE FABRIC
- REMOVE CONCRETE PAVEMENT
- TREE PROTECTION
- TREE REMOVAL

**SURVEY NOTES**

1. THE HORIZONTAL AND VERTICAL INFORMATION PROVIDED IS BASED ON THE MICHIGAN STATE PLANE COORDINATE SYSTEM (SOUTH ZONE, INTERNATIONAL FEET) WITH NAD83 DATUM.
2. SURVEY WAS COMPLETED IN OCTOBER 2015 AND REPRESENTS CONDITIONS AT THAT TIME.
3. UNDERGROUND UTILITIES ARE SHOWN BASED ON SURFACE MANHOLE AND VALVE LOCATIONS, AS-BUILT DRAWINGS AND CAMPUS UTILITY MAPS, AND MAY NOT BE ACCURATE. CONTRACTORS SHALL CONTACT MISS-DIG AND GVSU DIG PRIOR TO ANY DIGGING. CONTACT ENGINEER IF UTILITIES ARE FOUND IN DIFFERENT CONDITIONS THAN SHOWN ON THESE PLANS.
4. TREES ARE LABELED BY TRUNK DIAMETER. TREE DRIP LINES ARE NOT SHOWN TO SCALE.

**fishbeck**  
 Engineers | Architects | Scientists | Constructors

**Grand Valley State University**  
 10610 South Campus Drive, Allendale, MI 49401  
 Haas Performing Arts Center Garden

**REVISIONS**

NO.	DATE	DESCRIPTION
01/30/2023	FOR CONSTRUCTION	

Drawn By ADO  
 Designer MV  
 Reviewer  
 Manager MV

Hard copy is intended to be 24"x36" when plotted. Scale(s) indicated and graphic quality may not be accurate for any other size.

PROJECT NO. 221246  
 SHEET NO.







**C101**

**BENCHMARKS**

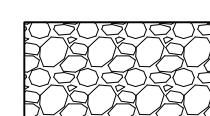
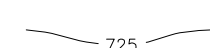
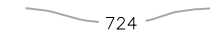
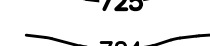
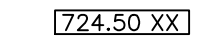
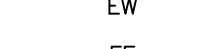
BENCH MARK A ELEVATION: 707.86  
CHISELED X ON NORTH BOLT OF BIG LIGHTPOLE BASE, SOUTH OF ZUMBERGE POND, BETWEEN KIRKHOFF PERFORMING ARTS CENTER AND ZUMBERGE

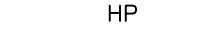
BENCH MARK B ELEVATION: 711.60  
CHISELED X ON TOP OF SSE BOLT ON LIGHT POLE BASE, WESTERLY SIDE OF SOUTH CAMPUS DRIVE, NORTH OF CALDER

**SYMBOL LEGEND**

-  CHIPS & FINES WALKWAY
-  725 EXISTING MAJOR CONTOUR
-  724 EXISTING MINOR CONTOUR
-  725 PROPOSED MAJOR CONTOUR
-  724 PROPOSED MINOR CONTOUR
-  724.50 XX SPOT ELEVATION
-  EW EDGE OF WALK
-  FF FINISH FLOOR
-  GR GRADE ELEVATION
-  HP HIGH POINT
-  LP LOW POINT

**LAYOUT NOTES**

1. DIMENSIONS ARE TO BACK OF CURB, OUTSIDE FACE OF BUILDING, AND EDGE OF PAVEMENT UNLESS NOTED OTHERWISE.
2. KEEP THE APPROVED AND/OR MOST CURRENT SET OF PROJECT DRAWINGS ON SITE AT ALL TIMES. CONTRACTOR TO CONFIRM THEY ARE IN POSSESSION OF THE MOST CURRENT DRAWING FILES.
3. BENCHES WILL BE FURNISHED AND INSTALLED BY THE CONTRACTOR AS AN ADD ALTERNATE #1 (PER EACH BENCH).
4. DECORATIVE FENCE WILL BE FURNISHED AND INSTALLED BY THE CONTRACTOR AS AN ADD ALTERNATE #2 (PER LUMP SUM).

**GRADING NOTES**

1. FINISH GRADE OF SOIL AND WALKWAY EDGES ALONG PAVEMENT TO MATCH EDGE OF PAVEMENT.
2. STRIP AND STOCKPILE TOPSOIL FROM GRADING AREAS. USE STOCKPILED TOPSOIL AND IMPORTED TOPSOIL AS NECESSARY FOR SURFACE RESTORATION.
3. GRADES SHOWN ARE FINAL SURFACE GRADES AFTER COMPLETION OF SURFACE IMPROVEMENTS AND PLACEMENT OF TOPSOIL.
4. GRADE AREAS AT SITE PERIMETER TO MATCH GRADES OF ADJACENT PARCELS.
5. PROVIDE TEMPORARY GRADING FEATURES SUCH AS BERMS, SWALES, SUMPS AND BASINS TO MANAGE INTERIM STORM WATER RUNOFF DURING CONSTRUCTION PROCESS. STORM WATER RUNOFF LEAVING THE SITE SHALL MEET ALL FEDERAL, STATE AND LOCAL QUALITY REQUIREMENTS.

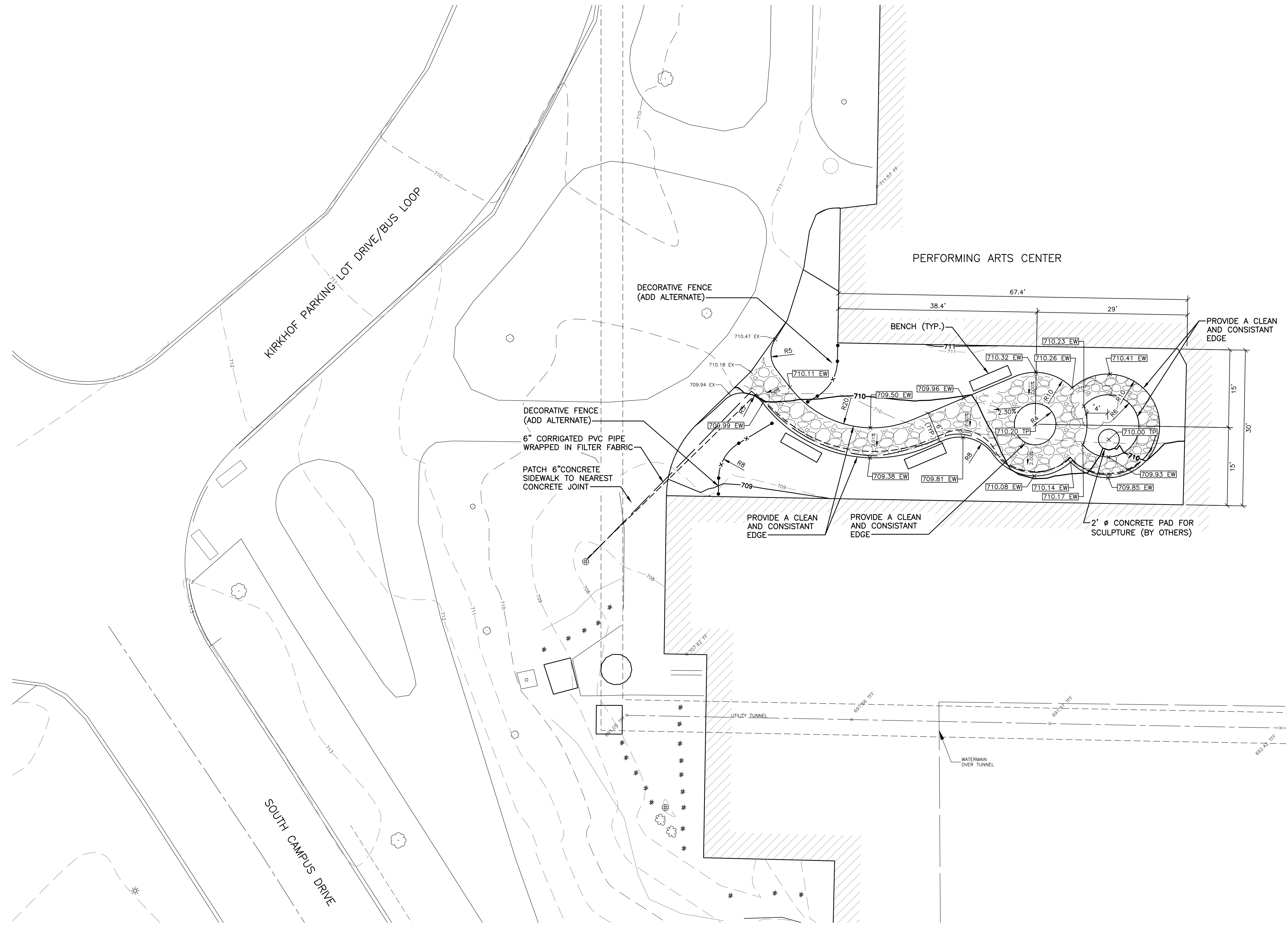

**SITE LAYOUT & GRADING PLAN**  
SCALE: 1" = 10'  
NORTH



*Mark Vysoky*

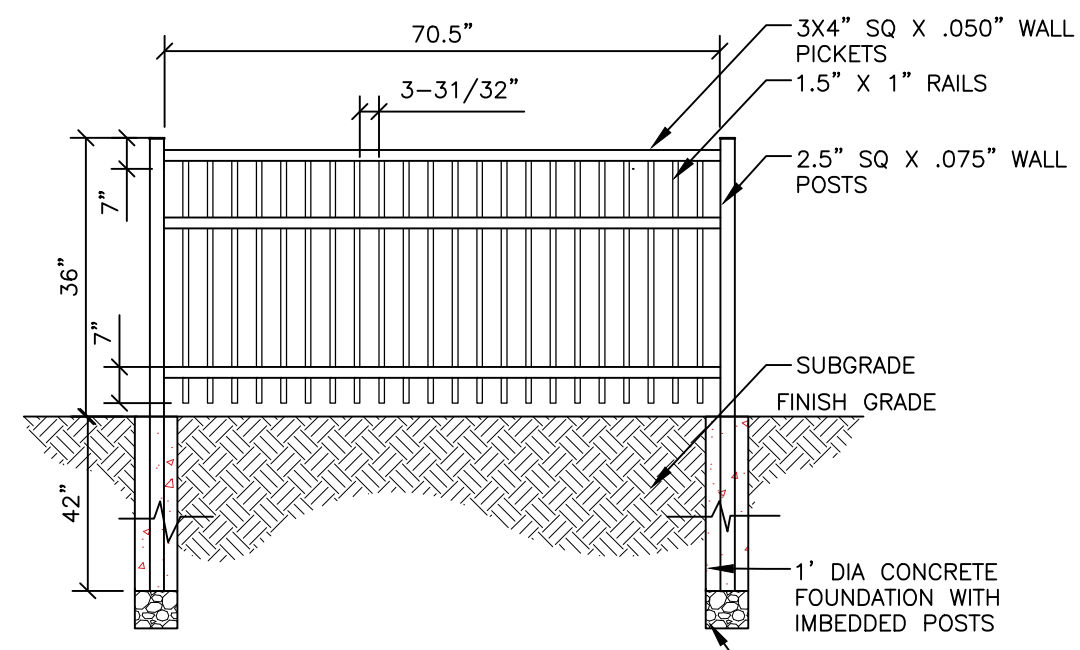

NOTES:  
- FURNISHED AND INSTALLED BY CONTRACTOR (ALTERNATE #2)  
- FENCE COLOR: WHITE (POWDER COATED)  
- FENCE PRODUCT 'JERITH PREMIER' BY JERITH.  
PHONE: 800-344-2242

**ORNAMENTAL FENCE DETAIL**  
NO SCALE

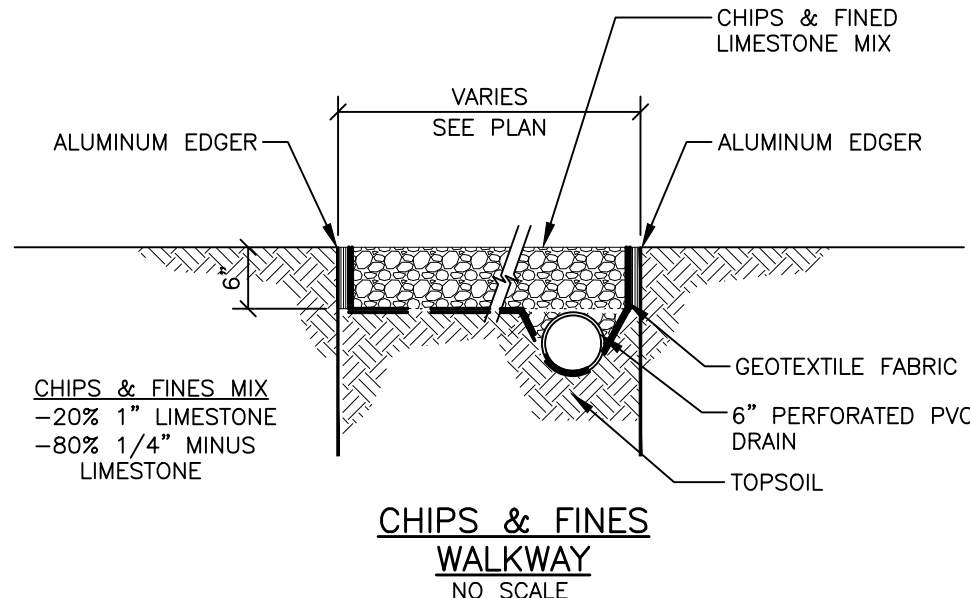

**CHIPS & FINES WALKWAY**  
NO SCALE

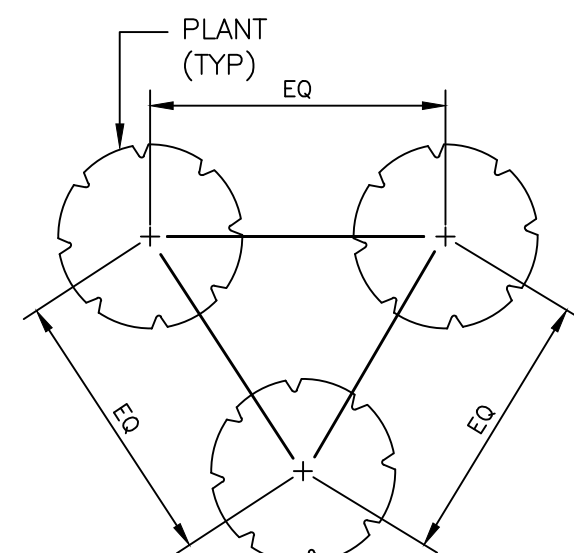

ALL SHRUBS, PERENNIALS, AND GROUND COVER PLANTED IN CLUSTERS SHALL BE SPACED WITH EQUAL TRIANGULAR SPACING.

**PLANT SPACING DETAIL**  
NO SCALE

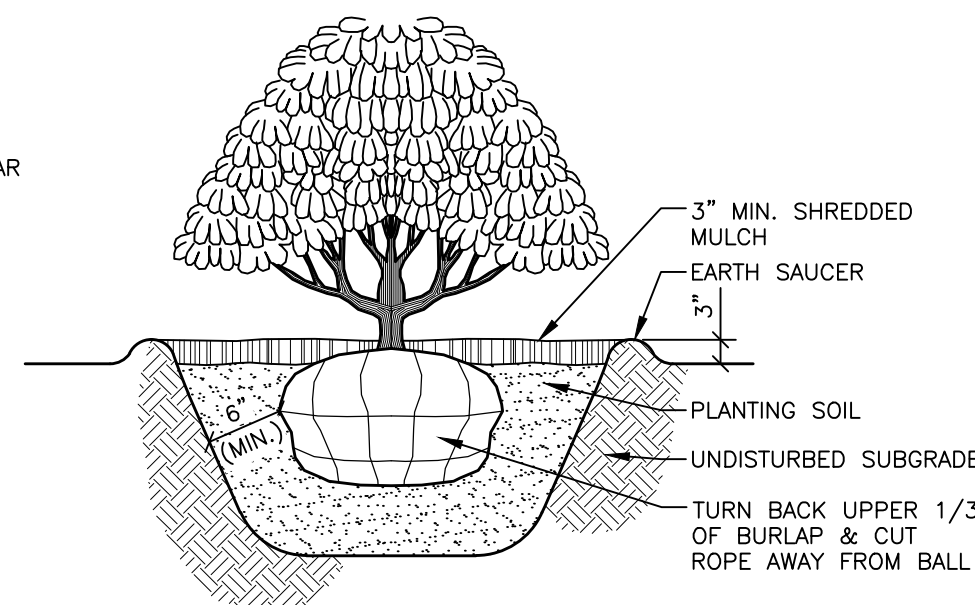

**SHRUB PLANTING DETAIL**  
NO SCALE

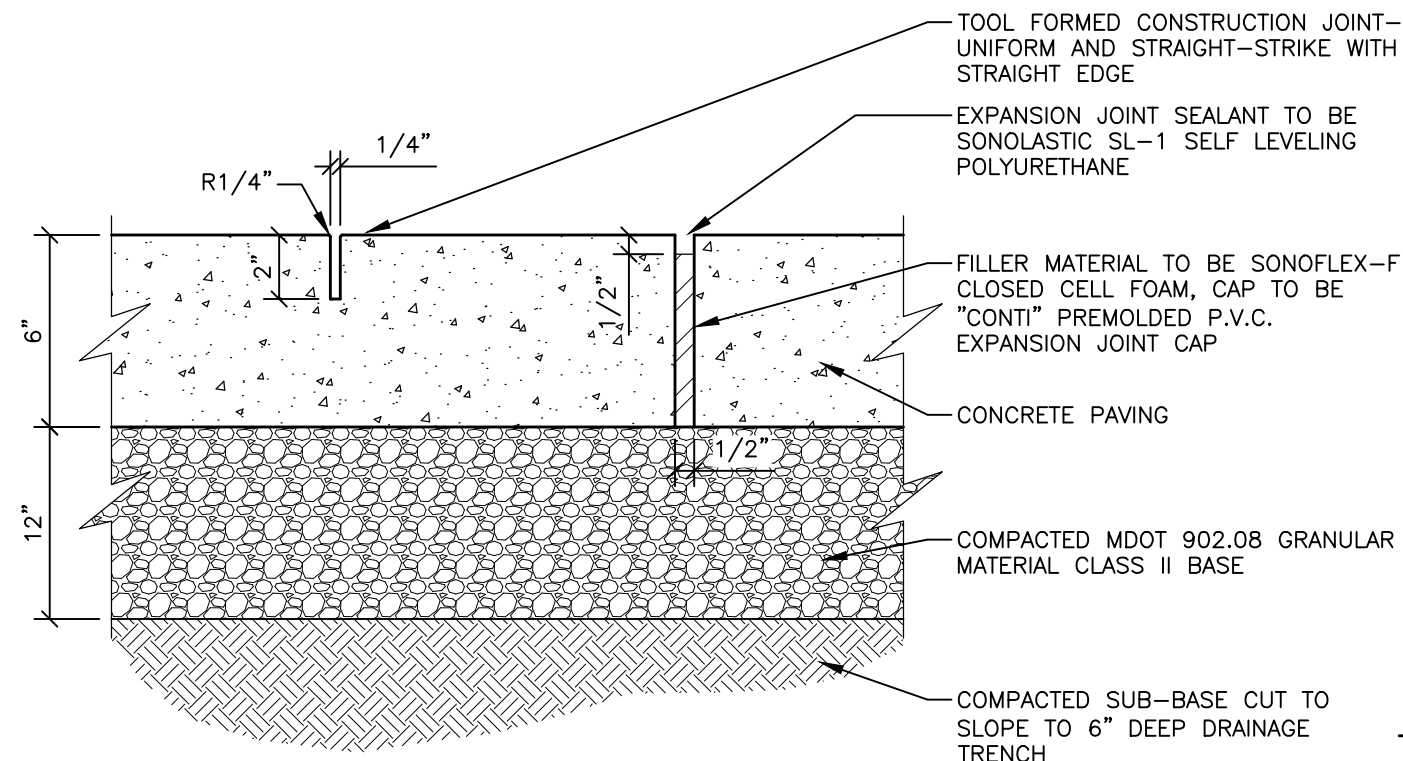

**CONTROL (CONTRACTION) JOINT SECTION**  
NO SCALE

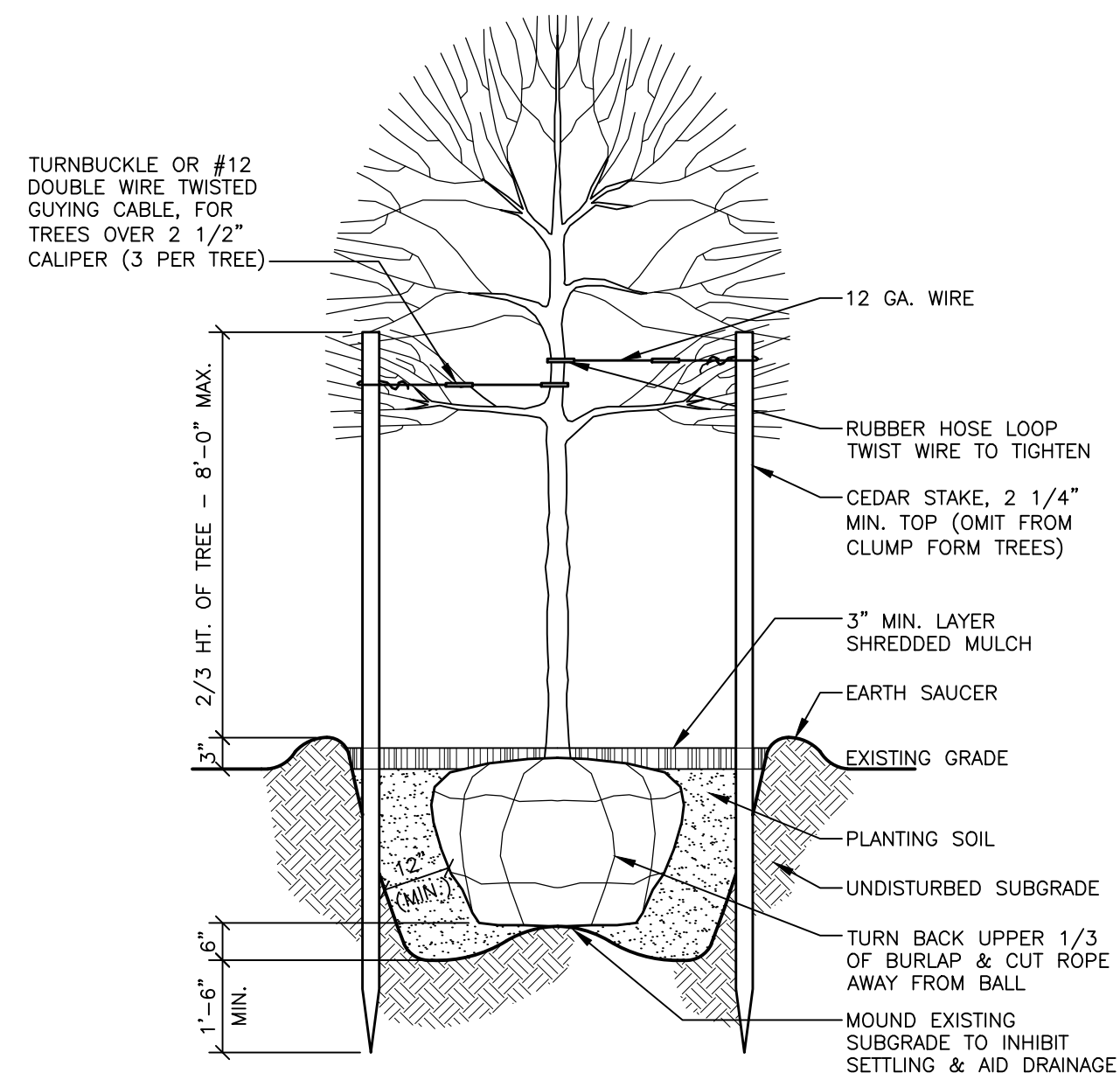

**TREE PLANTING DETAIL**  
NO SCALE  
(DETAIL TYP. FOR DECIDUOUS OR CONIFEROUS SPECIES)

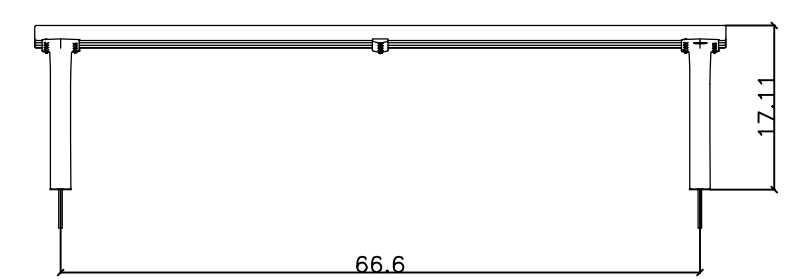
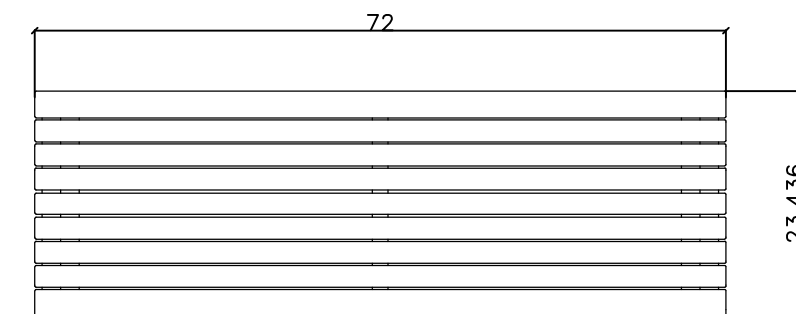

NOTES:  
- FURNISHED AND INSTALLED BY CONTRACTOR (ALTERNATE #1)  
- MANUFACTURER: LANDSCAPE FORMS KALAMAZOO, MI  
PHONE: 800-430-6206 X 1320  
- GENERATION-50 BENCH- BACKLESS, 23.5" X 72" X 17"

**BENCH**  
NO SCALE

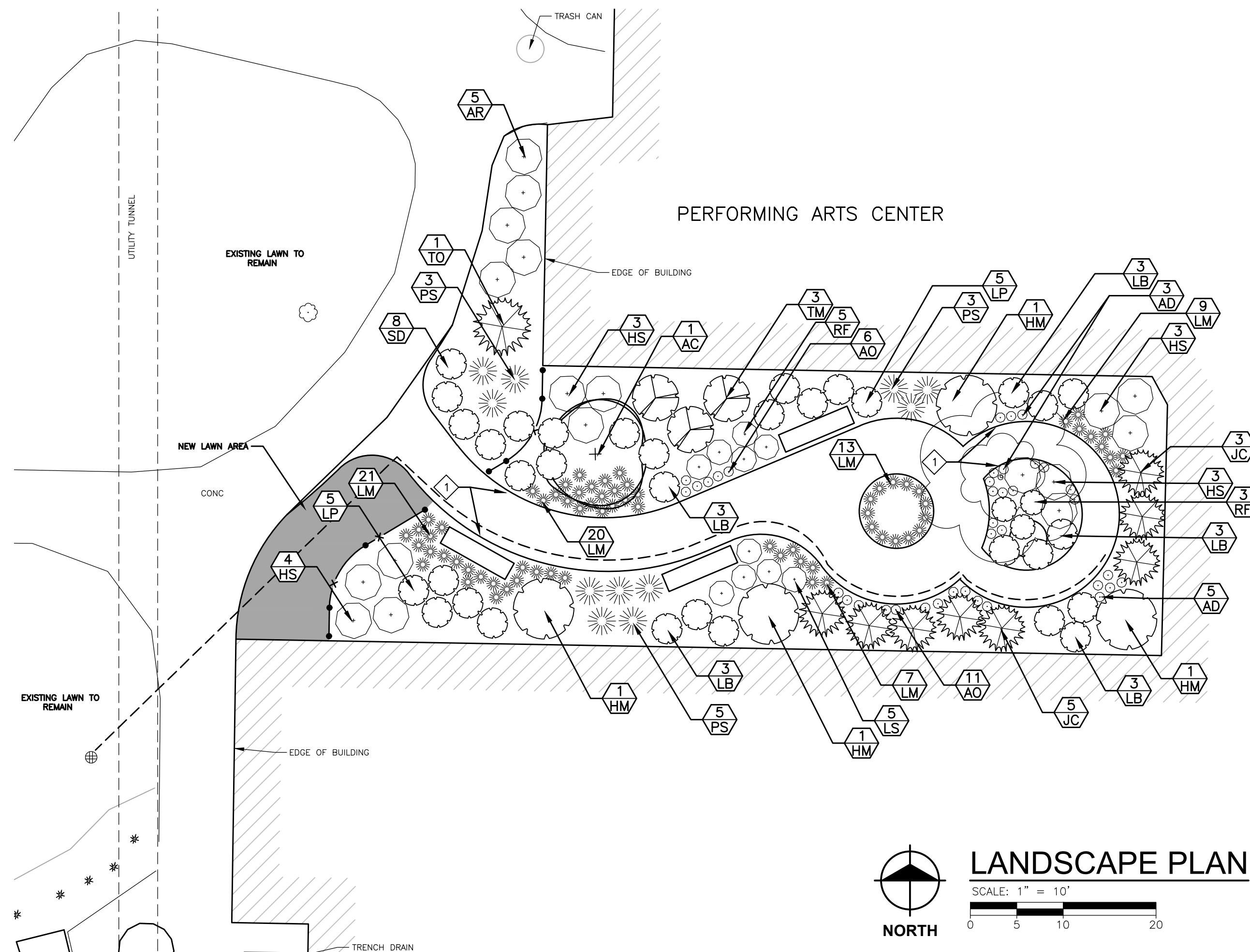

**LANDSCAPE PLAN**  
SCALE: 1" = 10'

**PLANT LIST**

PLANT TYPE	SYM.	BOTANICAL/COMMON NAME	QTY.	SIZE/CONDITION	
PERENNIALS	AD	ASTILBE 'DEUTSCHLAND'/DEUTSCHLAND ASTILBE	8	#1 CONT	
	AO	ASPERULA OODRATA/SWEET WOODRUFF	17	#1 CONT	
	HS	HOSTA 'SUM AND SUBSTANCE'/SUM AND SUBSTANCE HOSTA	13	#1 CONT	
	LB	LIGULARIA 'BOTTLE ROCKET'/BOTTLE ROCKET LIGULARIA	15	#1 CONT	
	LM	LIRIOPE MUSCARI VARIEGATA/LILYTURF VARIGATED	70	#1 CONT	
	LP	LUPINE PERINIS/ OUTSIDEPRIDE PERENNIAL LUPINE	10	#1 CONT	
	LS	LEUCANTHEMUM SUPERBUM/SHASTA DAISY	5	#1 CONT	
	PS	PENNISETUM SETACEUM RUBRUM/DWARF RED FOUNTAIN GRASS	6	#1 CONT	
	RF	RUDEBECKIA FULGIDA VAR. SULLIVANTII 'GOLDSTURM'/BLACK EYED SUSAN	8	#1 CONT	
	SD	STYLOPHORUM DIPHYLLUM/ CALENDINE POPPY	8	#1 CONT	
	SHRUBS	AR	ARONIA MELANOCARPA LOW SCAPE HEDGER INKBERRY	5	#3 CONT
		JC	JUNIPERUS CHINENSIS 'SPEARMINT'/SPEARMINT JUNIPER	8	5' B&B
		HM	HYDRANGEA MACROPHYLLA 'NIKKO BLUE'/NIKKO BLUE HYDRANGEA	4	#3 CONT
TREES	TM	TAXUS X MEDIA 'SEBIAN'/SEBIAN YEW	3	#3 CONT	
	AC	AMELANCHIER CANADENSIS/SHADBLow SERVICEBERRY	1	8' HT B&B, MULTI TRUNK	
	TO	THUJA OCCIDENTALIS 'EMERALD GREEN'/EMERALD GREEN ARBORVITAE	1	6' HT B&B	

**SYMBOL LEGEND**

- PERENNIALS/GROUND COVER
- ORNAMENTAL GRASS
- EVERGREEN SHRUBS
- DECIDUOUS SHRUBS
- DECIDUOUS ORNAMENTAL TREE
- DECIDUOUS SHADE TREE
- CONIFEROUS EVERGREEN TREE
- TURF SODDED AREA

**NOTES**

- REPORT ANY DISCREPANCIES BETWEEN THE PLANS AND THE ACTUAL CONDITIONS TO THE CONSTRUCTION MANAGER FOR RESOLUTION.
- FURNISH AND INSTALL 8" OF FURNISHED MODIFIED TOPSOIL FOR ALL PLANT BEDS, UNLESS OTHERWISE NOTED ON THE DETAILS, WITH A PH 7.0 THAT CONTAINS ALL THE MICROORGANISMS NECESSARY FOR HEALTHY PLANT GROWTH. THE CONTRACTOR SHALL PROVIDE SOIL SAMPLE AND SUPPLIER TO THE LANDSCAPE ARCHITECT FOR APPROVAL PRIOR TO DELIVERY.
- FURNISH AND INSTALL 4" OF FURNISHED MODIFIED TOPSOIL FOR ALL TURF SEEDER OR SODDED AREAS FOR FINE GRADING, UNLESS OTHERWISE NOTED.
- EXTRA CARE SHOULD BE TAKEN TO PREVENT TURF SEED OR NATURAL AREA SEED FROM GETTING INTO PLANT BEDS AND ADJACENT NATURAL AREAS.
- FURNISH AND INSTALL 2-3" OF SHREDDED HARDWOOD MULCH TO ALL PLANT BEDS AND TREE INSTALLATIONS. ALL TREES SHOULD HAVE A STRONG CENTRAL LEADER UNLESS NOTED OTHERWISE.
- ALL NURSERY STOCK SHALL BE FIRST CLASS QUALITY AND IN EXCELLENT HEALTH. THE LANDSCAPE ARCHITECT HAS THE RIGHT TO REJECT ALL MATERIALS THAT DO NOT MEET THE REQUIREMENTS OF THE PLANS AND SPECIFICATIONS.
- ALL NURSERY STOCK MATERIAL SHALL MEET ALL REQUIREMENTS OF THE SPECIFICATIONS.
- MAINTAIN 5' CLEARANCE FOR ALL TREES FROM MAJOR WATER, ELECTRIC, GAS, AND SEWER LINES. REPORT DISCREPANCIES WITH THE CONSTRUCTION MANAGER.
- ANY LANDSCAPE MATERIAL THAT FAILS WITHIN ONE YEAR FROM THE BUILDING OPENING SHALL BE REMOVED AND REPLACED.

**IRRIGATION NOTES**

**SITE IRRIGATION NOTES:**

- THERE IS AN EXISTING IRRIGATION SYSTEM AROUND THE PERIMETER OF THE GARDEN.
- THE OWNER WILL INSTALL A NEW SYSTEM.
- COORDINATE THE TIMING OF THE NEW IRRIGATION WITH THE OWNER.

**LAWN AREA SEED MIX**

COMMON NAME	PROPT BY WT	PURITY %	GERM
KENTUCKY BLUEGRASS	20%	95%	85%
IMPROVED TURF-TYPE	70%	95%	85%
TALL FESCUE	10%	95%	85%

01/30/2023 FOR CONSTRUCTION

Drawn By ADO  
Designer MAV  
Reviewer  
Manager MV

Hard copy is intended to be 24"x36" when plotted. Scale(s) indicated and graphic quality may not be accurate for any other size.

PROJECT NO.  
221246

SHEET NO.

**L101**



Mark Vysoky