

Joining a Zoom Webinar

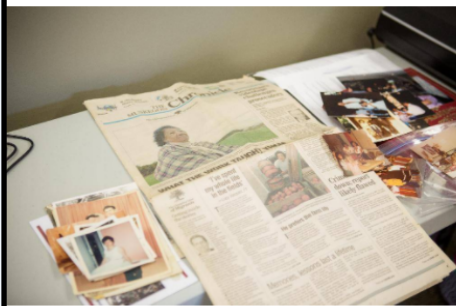

THE HISTORY OF WIDGETS

Wednesday, February 17, 2021 / 3:00 am - 4:00 pm

This webinar from the Kutsche Office of Local History explores the role widgets and widgetry played in 19th century West Michigan.

[Click here to join this webinar](#), or type <https://gvsu-edu.zoom.us/j/97047246509> into your browser.

If asked for a password, use: 214FR2

To join by phone, dial 312-626-6799 and enter the webinar ID 970-4724-6509

Click the link or type the URL into your browser.
Make note of the password.

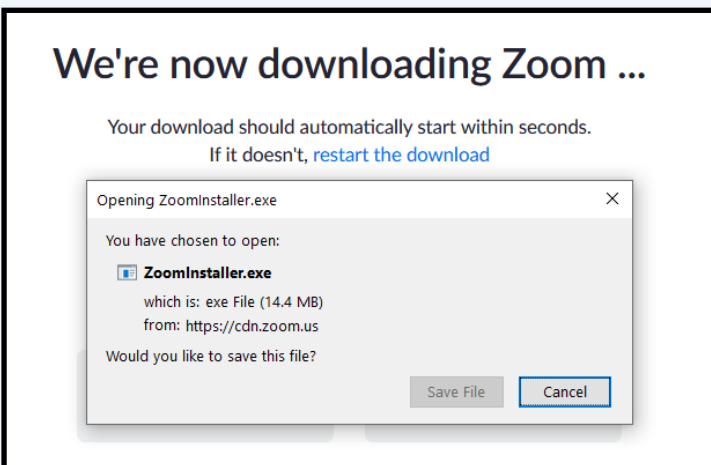

If you have not used Zoom on your device before, it will ask you to download and open a small file.

The download screen might look different based on what kind of device and web browser you are using.

If you have used Zoom on your device before, or have successfully downloaded the small file, Zoom will likely launch on its own.

If it does not open on its own, click Launch Meeting.

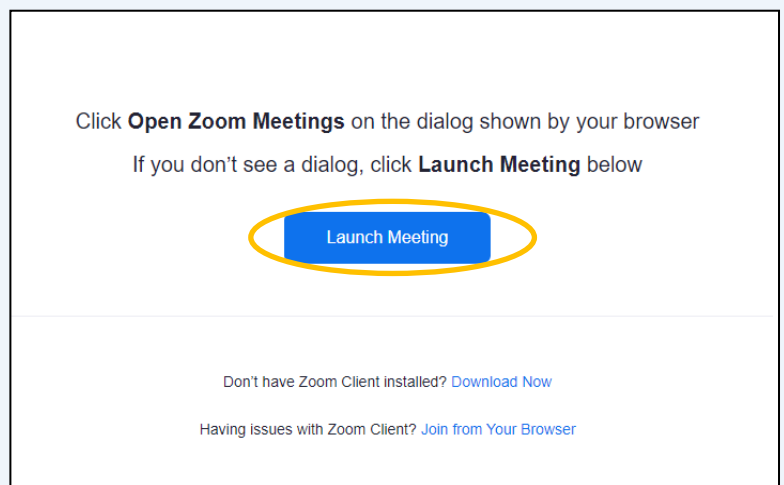

GVSU cybersecurity requires us to have a password and email address for everyone attending Zoom webinars.

If asked for a password, enter the password that was listed next to the web link.

When prompted, enter your email and name, then click Join Webinar.

Your name will be visible to all webinar attendees; you can use a nickname or only your first name if you prefer.

Your email address will only be visible to the webinar hosts.

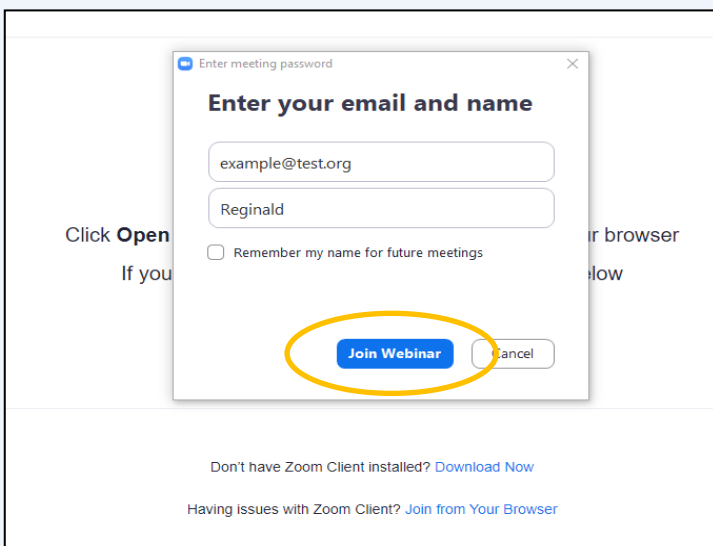
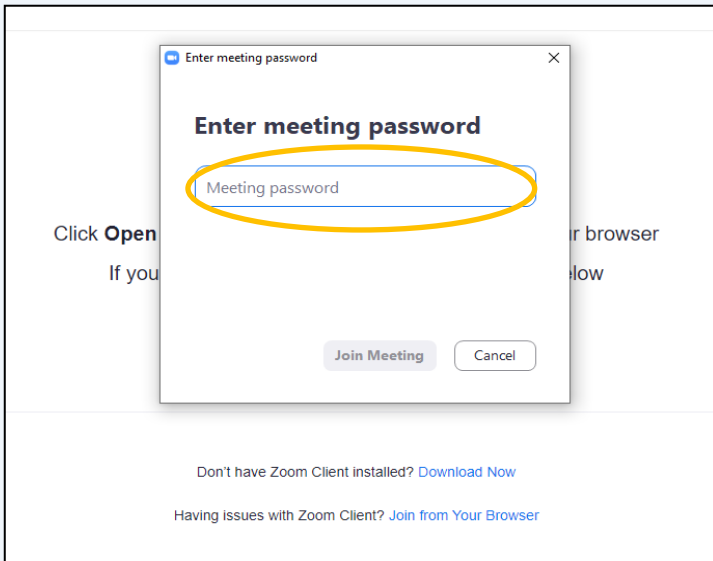

If you join before the webinar has begun, you will see a screen like this one, asking you to wait.

Once the webinar begins, you will automatically be taken into the webinar room.

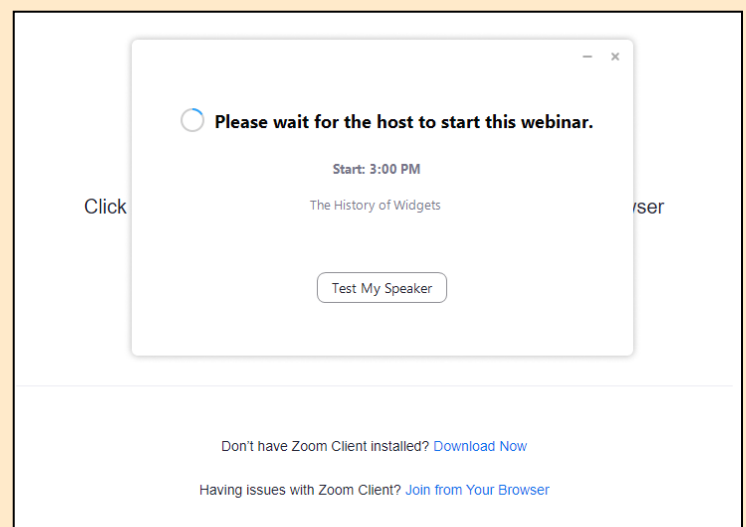



Once the webinar begins, your webpage will automatically update and take you into the Zoom webinar room.

We generally begin webinars with a still image letting you know that you are in the correct webinar, and giving people a few minutes to log in.

Presenters will join shortly and begin speaking.

To post a question for our presenters,
click the Q&A logo in the bottom-center.

If you need to leave the webinar early,
click the red Leave button in the bottom-right.

Contact us at kutsche@gvsu.edu or 616-331-8099 if you have any trouble.