

GVSU - Library Glass Replacement

North Facade Site Plan

Schedule:

-(May - July 2021)

Pedestrian Traffic:

- A 6' wide section of the clock tower access walk will remain open to pedestrians. The remaining sidewalk will be closed for material handling.
- Emergency Egress out of the NW corner of the building will be available at all times.

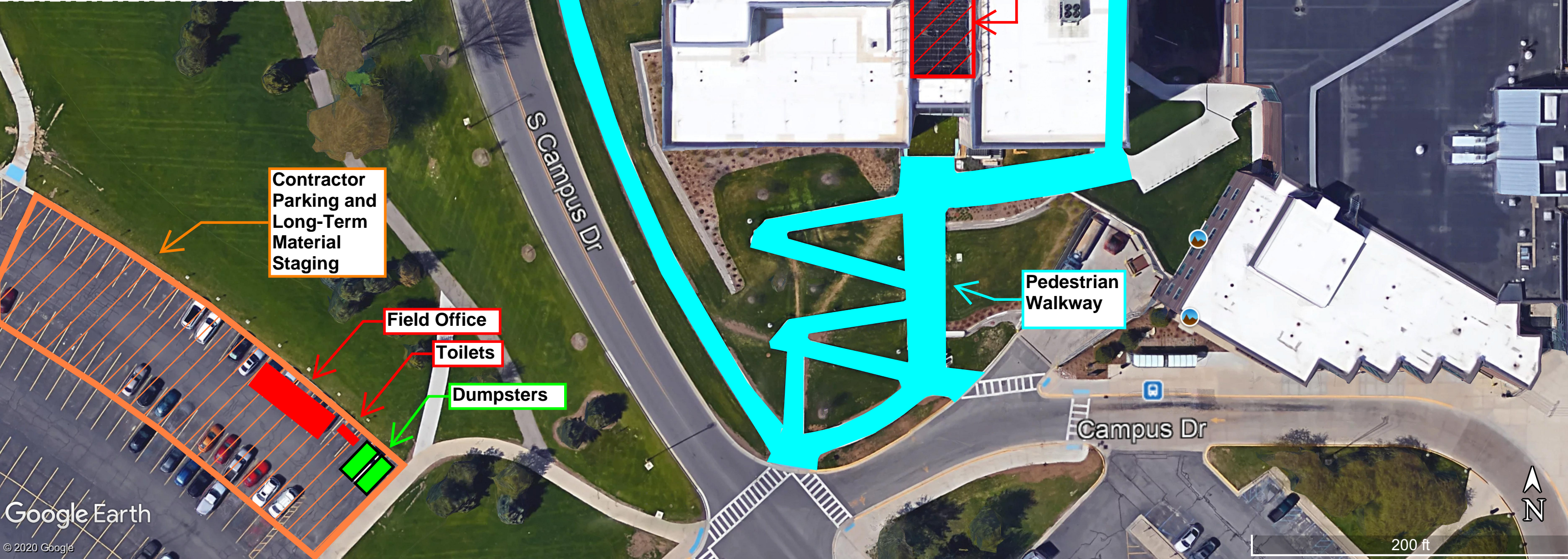



GVSU - Library Glass Replacement

West Facade Site Plan

Schedule:

- (August - September 2021)

Pedestrian Traffic:

- West sidewalk along Campus Drive will be closed off during the duration of the west facade work. Pedestrians can use the ramp/stairs on the south of the Library and will be routed north/south along the east sidewalk.
- A 6' wide section of the clock tower access walk will remain open to pedestrians. The remaining sidewalk will be closed for material handling.

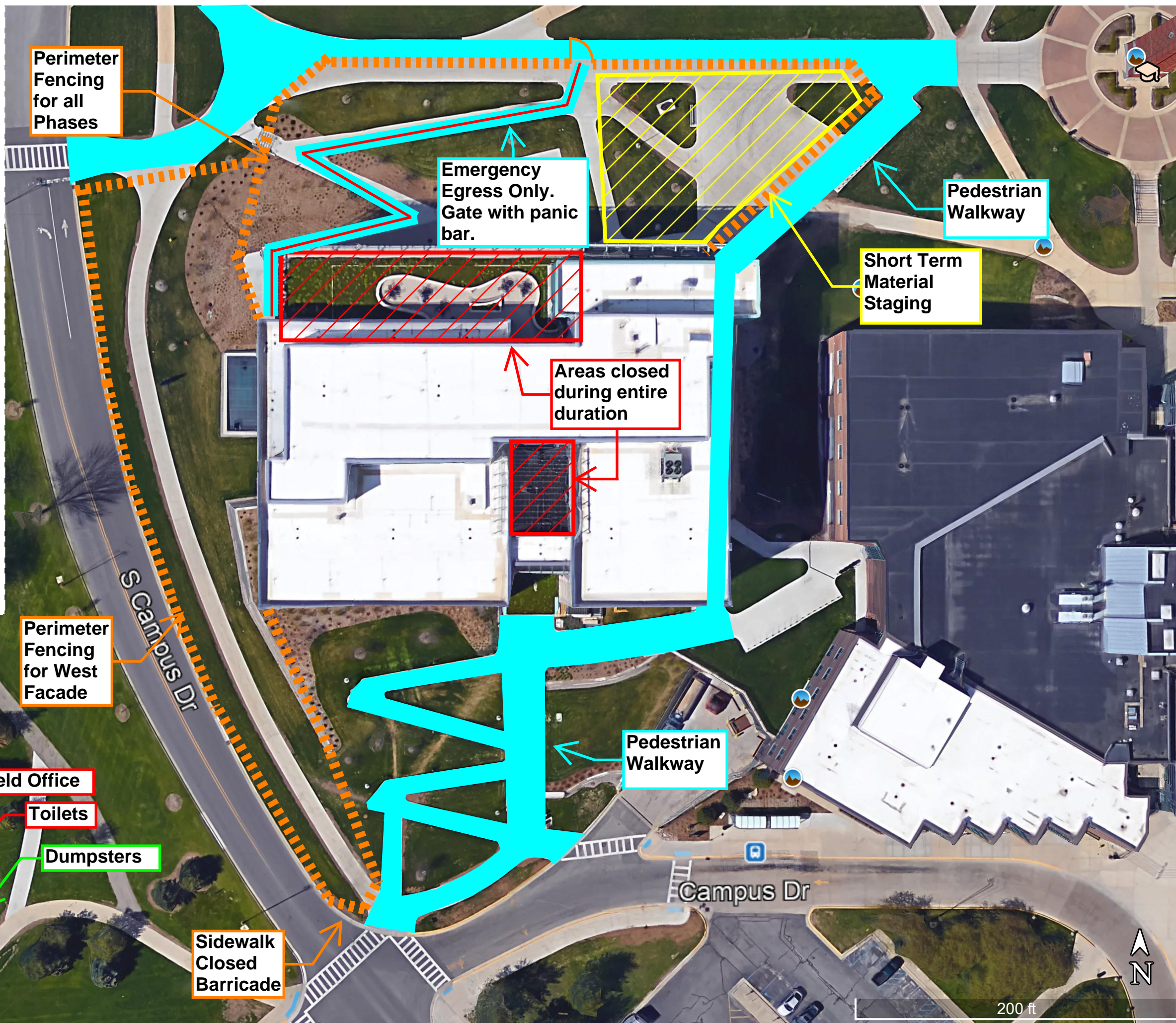



# GVSU - Library Glass Replacement

## South Facade Site Plan

### Schedule:

- (October - November 2021)

### Pedestrian Traffic:

- South Facade work - south entrance will remain closed and traffic will route to the west walk along Campus Drive. The northeast entrance will remain open.
- Kirkhof Center Egress. Barricades will direct traffic north. A clear path shall remain open at all times for safe egress out of Kirkhof Center.

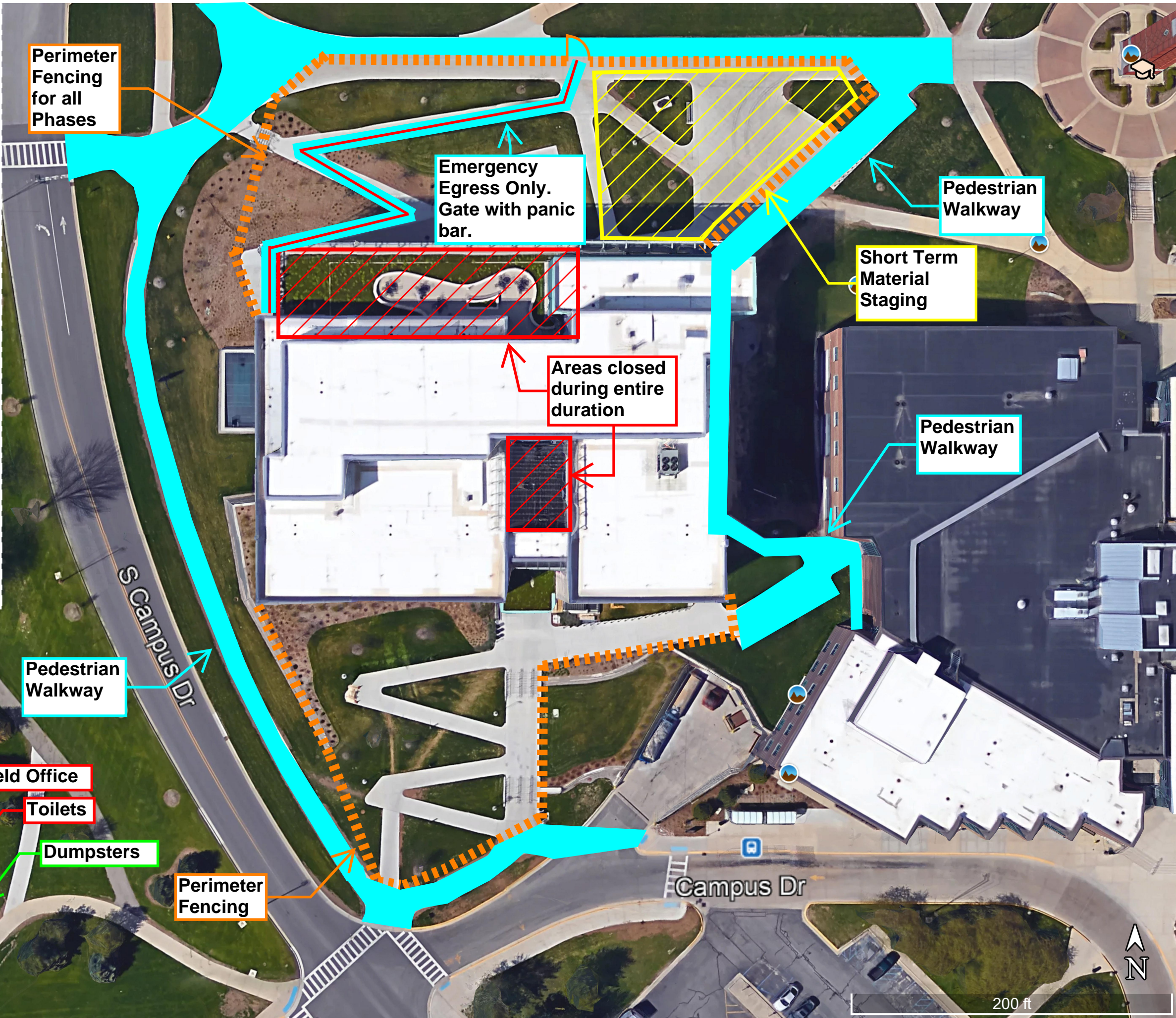



# GVSU - Library Glass Replacement

## East Facade Site Plan

### Schedule:

- (December 2021 - January 2022)

### Pedestrian Traffic:

- Library Emergency Egress out of the NE entrance will remain clear at all times. Signage will be placed directing egress traffic to exit site through gate with panic hardware.

-Kirkhof Center Egress. Barricades will direct traffic south. A clear path shall remain open at all times for safe egress out of Kirkhof Center.

