

FISCAL YEAR 2020
CAPITAL OUTLAY MAJOR PROJECT REQUEST

Institution Name: Grand Valley State University

Capital Outlay Code: 339X20C001

Request Code: 6113

Project Title: Computer Information Systems Classroom Building

Project Focus: ☒ Academic

☒ Research

☒ Administrative/Support

Type of Project: ☐ Renovation

☐ Addition

☒ New Construction

Approximate Square Footage: 100,000

Total Estimated Cost: \$50,000,000

Estimated Duration of Project: 4 Years

Is the Five-Year Plan posted on the department's public Internet site? ☐ Yes

Is the requested project included in the Five-Year Capital Outlay Plan? ☐ Yes

Project Purpose **Construct classrooms, teaching labs, faculty offices, student study spaces for computer information systems programs**

Scope of the Project **Design and construction of a new building**

Program Focus of Occupants **Computer information systems, information systems security**

Additional Information:

How does the project support Michigan's talent enhancement, job creation and economic growth initiatives on a local, regional and/or statewide basis?

Due to significant investment by employers in computer based systems, information security has become a priority for the data companies, hospitals and private industries. Information, security and related management employees are in demand and this demand is expected to continue.

How does the project enhance the core academic, development of critical skill degrees, and/or research mission of the institution?

GVSU is an academic institution whose growth in the computer information training fields has increased dramatically to meet the local employment market.

Is the requested project focused on a single, stand-alone facility? If no, please explain.

This is a stand alone facility, however it will be connected to an existing University funded building so utility resources can be shared and avoid some duplication of services.

How does the project support investment in or adaptive re-purposing of existing facilities and infrastructure?

Not applicable

Does the project address or mitigate any current health/safety deficiencies relative to existing facilities? If yes, please explain.

No, not applicable

How does the institution measure utilization of its existing facilities, and how does it compare relative to established benchmarks for educational facilities? How does the project help to improve the utilization of existing space and infrastructure, or conversely how does current utilization support the need for additional space and infrastructure?

New structure use will exceed the established benchmarks; existing buildings (which house these programs) exceeds 70% utilization and is used 7 days per week

How does the institution intend to integrate sustainable design principles to enhance the efficiency and operations of the facility?

GVSU has established LEED Silver as a minimum goal and we have more than 24 LEED certified buildings which represent nearly 30% of GVSU operated space.

Are match resources currently available for the project? If yes, what is the source of the match resources? If no, identify the intended source and the estimated timeline for securing said resources.

The land is University owned, matching resources will come from a combination of Campus Development Fund and University Donor Funds.

If authorized for construction, the state typically provides a maximum of 75% of the total cost for university projects and 50% of the total cost for community college projects. Does the institution intend to commit additional resources that would reduce the state share from the amounts indicated? If so, by what amount?

GVSU, as in recent projects, will provide funding in excess of the \$30 million State funding cap.

Will the completed project increase operating costs to the institution? If yes, please provide an estimated cost (annually, and over a five-year period) and indicate whether the institution has identified available funds to support the additional cost.

Yes, estimated operating cost for 5 years is expected to be \$708,750 annually (based on 2018 adjusted dollars), funding is available for the operations and maintenance of the proposed building.

What impact, if any, will the project have on tuition costs?

The University tuition will not increase as a result of this building coming on line.

If this project is not authorized, what are the impacts to the institution and its students?

Students interested in this programming will be unable to enroll in the expanding programs and students will be deprived of adequate space to train and study.

What alternatives to this project were considered? Why is the requested project preferable to those alternatives?

Without the proposed space, the University will not have the academic classrooms and lab space for the expanding program. There is no space at the Allendale campus which could support this proposed program expansion. Some space (located in 1960 era buildings) could be made available, but the electrical and mechanical systems of those spaces are not suitable for the proposed use. Where possible, the University has converted single classrooms to the proposed new use, however these conversions tax the existing electrical and mechanical systems of the existing building.

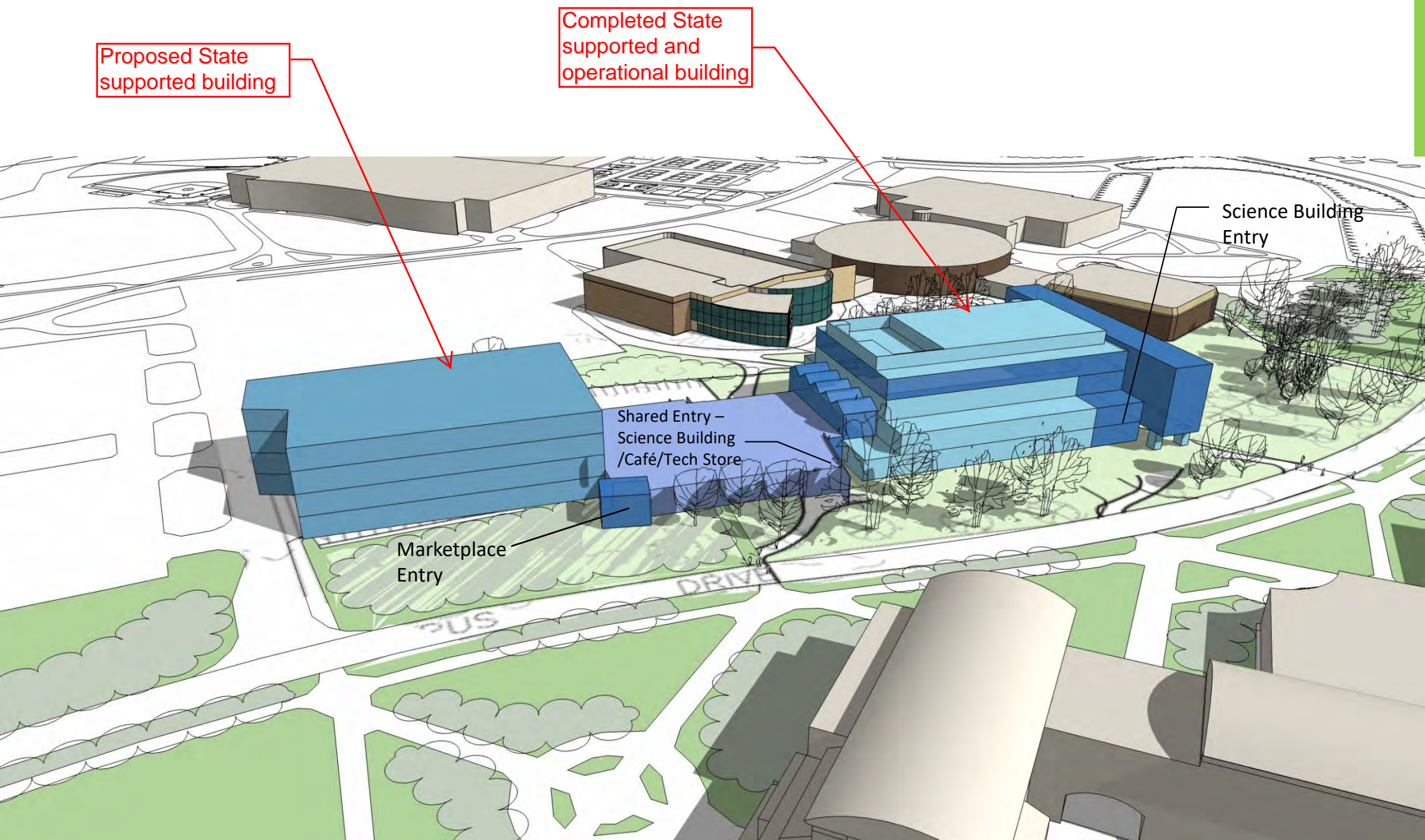

Concept 1

East Aerial | 4