

UNIVERSITY OF MICHIGAN MUSEUM OF ANTHROPOLOGY
FIELD SHEET - MICHIGAN ARCHAEOLOGICAL SITE SURVEY

County	Georgetown/Tallmadge	Site number	20-0773
OTTAWA	Township	Name	BLENOON'S LANDING
Section	GEORGETOWN ALLENDALE	USGS Quadrangle	ALLENDALE
32 NE 1/4 OF NW 1/4	Range R13W	Classification	HISTORIC
Owner	Address	1840-1965	
WM. PETERSON	Address		
Occupant			
Attitude toward excavation		Possibility of destruction	EXCAVATED BY GUSC
Type of site		Approximate size	
RIVER LANDING			
LOGGING			
Topography		Kind of soil	
700' BLUFF ABOVE THE RIVER			
Surface features		Nearby water source	GRAND RIVER
Vegetation			
If within a mile of a shore of one of the Great Lakes give estimated or measured distance above the water level.			
Type of artifacts from site		Surface collections	
GLASS, NAILS, CERAMICS			
Location of collections		Excavated Material	TEST PITS ON BLUFF
GUSC			
Catalog numbers			
600-634			
Published references			
Unpublished references (Manuscripts, notes)			
A PRELIMINARY SURVEY OF THE LOWER GRAND RIVER VALLEY 1974			
ROBERT G. KINGSLEY & ROBERT S. FLANDERS.			
Photographic record			
Source of this information			
Actual visit to site		Correspondence	
Publications		Conversation	
Unpublished accounts			
This record by		Date	
Remarks			
HOTEL, HOUSES, SAWMILL, LOG ROLLAWAY, NARROW GAUGE RAILROAD, BRICK YARD			
SHED YARD			

Accessibility

Road to site

Number of gates

Describe any buildings on site

Present use of site

In urban, agricultural, or wilderness area

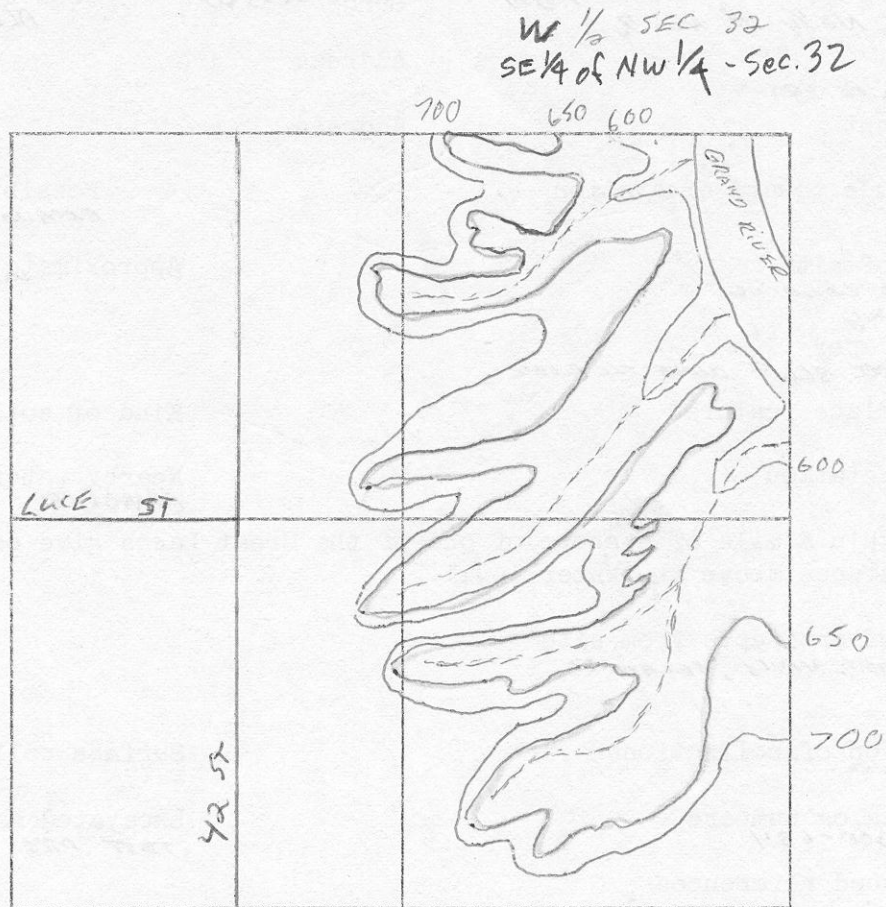

Above is a blank plat that may be used to represent a county, a township, four sections, or one section according to the requirements of a precise location for the site. In any case named or numbered roads can be drawn in. If the county subdivisions are not used it should be so stated.

When sections or townships are not square, as in the case along the coastlines, the shape can be sketched in with this blank plat as a base.

One of the four directions must be indicated.

When a site is measured to a cross-roads that is too far away to be shown on this plat, a line of dashes (-----), with the distance indicated, can show the direction in which the cross-roads lie .